



## Main Street, Wymondham

A delightful three bedroom stone character cottage situated in the heart of this popular village, the property has been very well looked after by the current vendor and has been updated throughout.



### FEATURES

- Charming Stone Cottage
- Well-Maintained Throughout
- Modern Kitchen Diner
- Generous Living Room
- Cellar Access
- Three Bedrooms
- Low Maintenance Gardens
- Village Location
- Excellent Transport Links



Accommodation comprises modern fitted, well appointed kitchen diner which has been recently redecorated and offers plenty of storage, downstairs WC, generous living room with open fire and bay window, a further storage cupboard and a door leading to the cellar.

To the first floor is two double bedrooms, one with built in storage, one single bedroom and a shower room.

To book a viewing call our area experts

[www.mooresestateagents.com](http://www.mooresestateagents.com)

Moore's Property Hub 01572 757979 | Moore's Move to the Country 020 301 11361  
Melton 01664 491610 | Uppingham 01572 821935 | Stamford 01780 484555  
Grantham Meet & Greet 01476 855618 | Peterborough Meet & Greet 01733 788888  
A1 Meet & Greet Stoke Rochford | [office@mooresestateagents.com](mailto:office@mooresestateagents.com)



Externally the property has a pretty front access with a small front garden mainly paved with flower beds and a stone wall boundary, to the rear is the raised, paved rear garden offering privacy and low maintenance.

Wymondham is a pretty village on the border of Leicestershire and Rutland. The village is serviced by a well-regarded pub, primary school and windmill with tearoom and boutique shops. The attractive market towns of Melton Mowbray and Oakham are both within easy reach, both offering a further range of amenities including an excellent range of shops, restaurants and bars. Education is well renowned with both public and state schooling for all ages available in Melton Mowbray, Grantham, Oakham, Uppingham, Witham, Stamford and Oundle. For commuters, Wymondham is within close proximity to the A1 giving access to both Grantham and Peterborough with mainline trains to London in approximately one hour. Rutland Water is approximately 11 miles to the south and provides a wide range of outdoor leisure pursuits from water sports to trout fishing and the nature reserve.

To book a viewing call our area experts

[www.mooresestateagents.com](http://www.mooresestateagents.com)

Moore's Property Hub 01572 757979 | Moore's Move to the Country 020 301 11361  
Melton 01664 491610 | Uppingham 01572 821935 | Stamford 01780 484555  
Grantham Meet & Greet 01476 855618 | Peterborough Meet & Greet 01733 788888  
A1 Meet & Greet Stoke Rochford | [office@mooresestateagents.com](mailto:office@mooresestateagents.com)

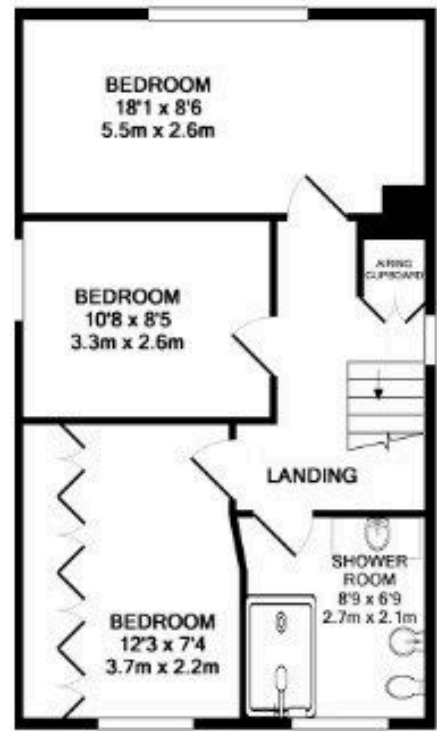

**EPC RATING**

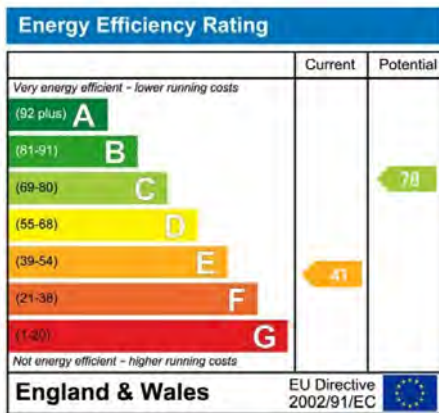

**To book a viewing call our area experts**

Moores Property Hub 01572 757979  
 Moores Move to the Country 020 301 11361  
 Melton 01664 491610  
 Uppingham 01572 821935  
 Stamford 01780 484555  
 Grantham Meet & Greet 01476 855618  
 Peterborough Meet & Greet 01733 788888  
 A1 Meet & Greet Stoke Rochford

office@mooresestateagents.com

**Follow us for Property Updates**



@mooresestateagents



@mooresestateagents

**www.mooresestateagents.com**

**Click the images below to view our Area Minute Guides**

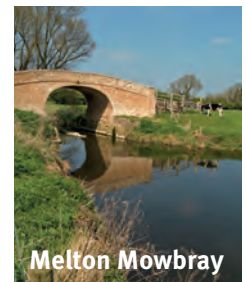
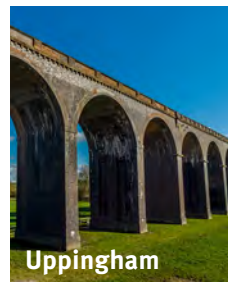
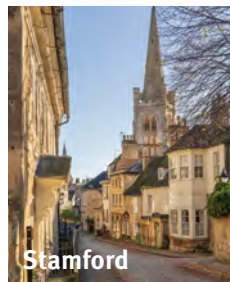

Moore V Ltd trading as Moores Estate Agents gives notice that: 1. These particulars do not constitute an offer or contract or part thereof. 2. All descriptions, photographs and plans are for guidance only and should not be relied upon as statements or representations of fact. All measurements are approximate and not necessarily to scale. Any prospective purchaser must satisfy themselves of the correctness of the information within the particulars by inspection or otherwise. 3. Moore V Ltd trading as Moores Estate Agents does not have any authority to give any representations or warranties whatsoever in relation to this property (including but not limited to planning/building regulations), nor can it enter into any contract on behalf of the Vendor. 4. Moore V Ltd trading as Moores Estate Agents does not accept responsibility for any expenses incurred by prospective purchasers in inspecting properties which have been sold, let or withdrawn. 5. If there is anything of particular importance to you, please contact this office and we will try to have the information checked for you.